



INSTRUCTION SHEET FOR TOOL #981

6-SPEED MAIN DRIVE GEAR INSTALLER

USE ON 2006 TO PRESENT DYNA 6-SPEED MODELS

USE ON 2006 TO PRESENT XL'S & BUELL TWINS

WHEN PERFORMING OTHER TRANSMISSION RELATED SERVICE USE THE FOLLOWING TOOLS:

- JIMS No.2315 6-speed primary locker tool
- JIMS No.989 6-speed mainshaft pulley nut socket
- JIMS No.984 6-speed trans door remover
- JIMS No.987 6-speed main case bearing installer
- JIMS No.986 6-speed main drive gear bearing & seal installer
- JIMS No.985 6-speed shift fork shaft remover

Note: Do not use a impact wrench on this tool
Note: Read complete instructions before starting task

1. Refer to H.D. Service Manual per model your working on to remove access door, shift drum, gear set, shift drum, shift forks, and any service, you need to perform. On Buell and Sportster models follow the same instruction below. See factory service manual to pull motor and split cases to get access to transmission.
2. When you are at the point of installing the main drive gear into the the case and you have the main case bearing installed, then take #1 gear plate and #2 screw and insert thru plate. Lube threads of screw. Then insert the screw and gear plate thru your main drive gear with the plate facing against the big end of the gear.
3. Lube your main drive gear and o-ring on the surface where bearing sits on gear. Position your lubed main drive gear with #1 plate and #2 screw centered up against the case bearing from inside the case.
4. Item #2 screw should be protruding outside the case. Attach in the following order onto #2 screw, #5 installer cup centered against inner case bearing race as shown above. The installer cup should be positioned centered over the end of the inner bearing race. Install bearing #4, then washer #6, and then nut #3.
5. Use a slightly angled 3/4" box end wrench and attach to head of screw thru top lid cover area as shown above. Then with another 3/4" wrench or socket turn nut clockwise until gear seats against case bearing.

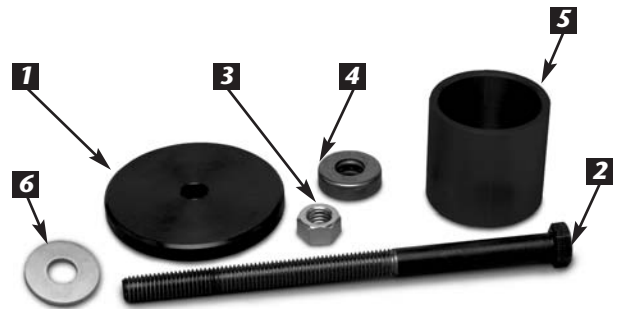
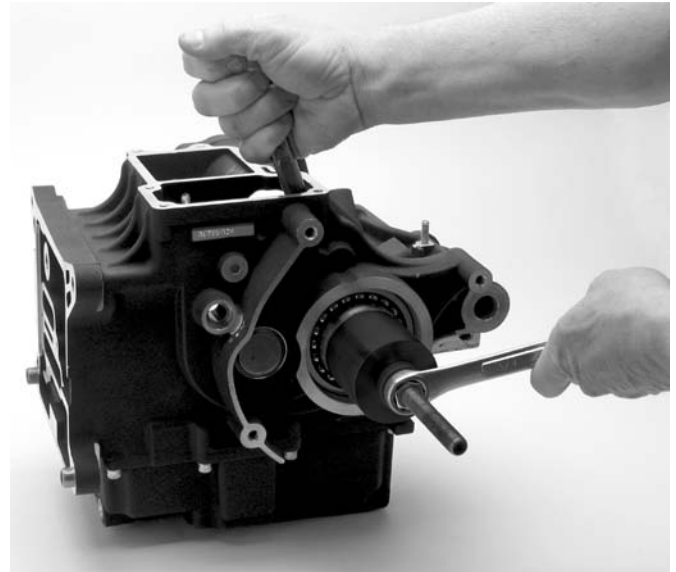

PARTS AVAILABLE SEPARATELY

No.	Qty.	Description	Part No.
1	1	GEAR PLATE	35316-80-7
2	1	SCREW	2137
3	1	NUT	2136
4	1	BEARING	2010
5	1	INSTALLER CUP	981-1
6	1	WASHER	2038

CAUTION: WEAR SAFETY GLASSES. EXCESSIVE FORCE MAY DAMAGE PARTS!
SEE JIMS® CATALOG FOR HUNDREDS OF TOP QUALITY PROFESSIONAL TOOLS.
THE LAST TOOLS YOU WILL EVER NEED TO BUY.

Performance Parts For Harley-Davidson Motorcycles