



*Impact Sockets,
Chisels & Attachments*

EVERYTHING IMPACT.®





GP is **EVERYTHING IMPACT**®

Grey Pneumatic (GP) through our distributors supplies the world's automotive, industrial, assembly, mining, maintenance, construction, and energy industries with heavy duty, high quality impact and specialty sockets. We carry a complete line of Impact Socket sets and individuals from 1/4" drive thru 2-1/2" and #5 spline drive with hex sizes up to 8". We also offer a large selection of star impact drivers, impact hex drivers, triple square drivers, torque limiting extensions plus Impact chisels and accessories.

GP sockets and tools are made in Taiwan using the highest quality chrome-molybdenum alloy steel and state-of-the-art manufacturing processes and equipment. Thorough and exact heat treatment, as well as rigid quality control, ensures the correct balance of strength and durability to deliver outstanding performance at the most competitive cost.

GP Tools are available through Automotive and Industrial warehouse distributors, tool stores, mobile tool truck dealers, tire equipment and supply warehouses and other sources that service these markets.

GP offers **Fast and Reliable** service to all of our distributors and their customers.



*GP Tools carry a
Lifetime Warranty.*

All GP Impact Sockets feature the GP "High Torque" Drive

Benefits are:

Increased Strength - Transfers the pressure from the thinnest part of the socket wall toward the thicker section, resulting in increased strength.

Increased Torque - Allows up to 20% more torque to be applied than on standard hex impact sockets.

Easier Access to Tight Areas - The shift in pressure allows us to reduce the socket wall thickness, increasing access to tight areas.

Reduced Wear - Our impact sockets grip the fastener across a broader contact area, reducing the chance of rounding off fasteners.



*GP "High Torque"
drive offers many
benefits.*



*All GP Sockets feature
extra-large size markings
for quick identification.*

EVERYTHING IMPACT®



1/2" Drive Standard Length Impact Sockets



6 1/2" Drive - Standard Length - Fractional Sizes SAE



ANSI Specifications B107.2

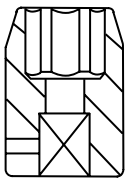

SHAPE I

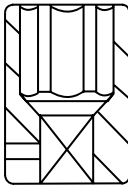

SHAPE II

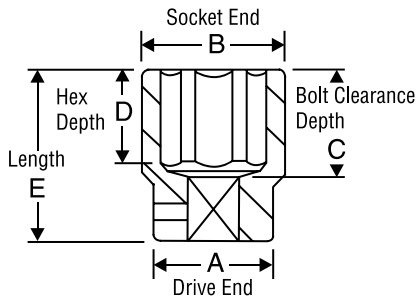

SHAPE III

Item Number	Hex Size	Shape	Dimensions (Inches)				
			A	B	C	D	E
2010R	5/16"	I	.87	.59	.83	.35	1.50
2012R	3/8"	I	.87	.63	.83	.47	1.50
2014R	7/16"	I	.87	.71	.83	.47	1.50
2016R	1/2"	I	.87	.79	.83	.47	1.50
2018R	9/16"	I	.94	.87	.83	.47	1.50
2020R	5/8"	II	.98	.98	.83	.47	1.50
2022R	11/16"	II	1.02	1.02	.83	.51	1.50
2024R	3/4"	II	1.10	1.10	.83	.51	1.50
2026R	13/16"	II	1.18	1.18	.83	.55	1.50
2028R	7/8"	II	1.26	1.26	.83	.59	1.50
2030R	15/16"	II	1.34	1.34	.83	.59	1.50
2032R	1"	II	1.42	1.42	.83	.59	1.50
2034R	1-1/16"	II	1.50	1.50	.91	.67	1.57
2036R	1-1/8"	III	1.50	1.57	.91	.67	1.57
2038R	1-3/16"	III	1.50	1.65	.91	.67	1.57
2040R	1-1/4"	III	1.50	1.73	.91	.67	1.57
2042R	1-5/16"	III	1.50	1.77	1.02	.75	1.69
2044R	1-3/8"	III	1.50	1.91	1.30	.94	1.97
2046R	1-7/16"	III	1.50	1.99	1.30	.94	1.97
2048R	1-1/2"	III	1.50	2.07	1.30	.94	1.97
2050R	1-9/16"	III	1.73	2.20	1.69	.94	2.36
2052R	1-5/8"	III	1.73	2.30	1.69	1.06	2.36
2054R	1-11/16"	III	1.73	2.40	1.69	1.06	2.36
2056R	1-3/4"	III	1.73	2.48	1.69	1.06	2.36
2058R	1-13/16"	III	1.73	2.56	2.09	1.18	2.76
2060R	1-7/8"	III	1.73	2.66	2.09	1.18	2.76
2062R	1-15/16"	III	1.73	2.72	2.09	1.18	2.76
2064R	2"	III	2.05	2.80	2.09	1.26	2.76
2066R	2-1/16"	III	2.05	2.85	2.09	1.26	2.76
2068R	2-1/8"	III	2.05	2.95	2.09	1.26	2.76
2070R	2-3/16"	III	2.05	3.01	2.09	1.38	2.76
2072R	2-1/4"	III	2.05	3.07	2.09	1.38	2.76

6 Standard Length - Metric Sizes MM

Item Number	Hex Size	Shape	Dimensions (Millimeters)				
			A	B	C	D	E
2008M	8mm	I	22	15.0	21	9	38
2009M	9mm	I	22	15.0	21	12	38
2010M	10mm	I	22	17.0	21	12	38
2011M	11mm	I	22	19.0	21	12	38
2012M	12mm	I	22	19.0	21	12	38
2013M	13mm	I	24	20.0	21	12	38
2014M	14mm	I	24	22.0	21	12	38
2015M	15mm	I	25	23.0	21	12	38
2016M	16mm	II	25	25.0	21	12	38
2017M	17mm	II	26	26.0	21	13	38
2018M	18mm	II	26	26.0	21	13	38
2019M	19mm	II	28	28.0	21	13	38
2020M	20mm	II	30	30.0	21	13	38
2021M	21mm	II	30	30.0	21	13	38
2022M	22mm	II	32	32.0	21	13	38
2023M	23mm	II	32	32.0	21	13	38
2024M	24mm	II	34	34.0	21	13	38
2025M	25mm	II	36	36.0	21	14	38
2026M	26mm	II	36	36.0	21	14	38
2027M	27mm	II	38	38.0	23	17	40
2028M	28mm	III	38	40.0	23	17	40
2029M	29mm	III	38	40.0	23	17	40
2030M	30mm	III	38	42.0	23	17	40
2032M	32mm	III	38	44.0	23	17	40
2033M	33mm	III	38	45.0	26	19	43
2034M	34mm	III	38	46.0	33	24	50
2035M	35mm	III	38	48.5	33	24	50
2036M	36mm	III	38	48.5	33	24	50