

Locking Extensions

SureGrip® Lock for Safety

New through lock, solid body design significantly improves strength. The SureGrip® lock grabs each socket and doesn't let go. This eliminates the problem of sockets remaining stuck to a fastener (usually in a hard-to-reach location), or sockets being dropped when the tool is removed from a tight compartment. With the SureGrip® lock, you can count on optimal tool control and peace of mind.

1/4" Drive Locking Extensions

PART NO.	SIZE	A	B	D
40991	3"	0.50	0.48	3.40
40992	7"	0.50	0.48	7.25
40994	15"	0.50	0.48	15.36

No. 4941

3 Piece, 1/4" Drive Locking Extension Set Includes:

PART NO.	SIZE	PART NO.	SIZE	PART NO.	SIZE
40991	3"	40992	7"	40994	15"

Packaged in a plastic tray.

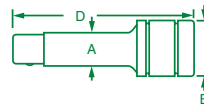

Standard Sockets

SuperKrome® Finish

High polish SuperKrome® plating results in a jewelry-like finish, providing long life and maximum corrosion resistance.



No. 4910

10 Piece, 1/4" Drive, 6 Point, Standard Fractional Socket Set Includes:

PART NO.	SIZE	PART NO.	SIZE	PART NO.	SIZE	PART NO.	SIZE
40906	3/16"	40909	9/32"	40912	3/8"	40918	5/16"
40907	7/32"	40910	5/16"	40914	7/16"		
40908	1/4"	40911	11/32"	40916	1/2"		

Packaged on a rail.



1/4" Drive, 6 and 12 Point Standard Fractional Sockets

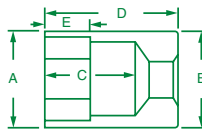

6 POINT PART NO.	12 POINT PART NO.	HEX SIZE	A	B	C	D	E
40904	—	1/8"	0.24	0.47	0.41	0.87	0.14
40905	—	5/32"	0.28	0.47	0.41	0.87	0.11
40906	43906	3/16"	0.31	0.47	0.51	0.87	0.10
40907	43907	7/32"	0.34	0.47	0.51	0.87	0.11
40908	43908	1/4"	0.38	0.47	0.51	0.87	0.13
40909	43909	9/32"	0.42	0.47	0.51	0.87	0.28
40910	43910	5/16"	0.47	0.47	0.51	0.87	0.36
40911	43911	11/32"	0.50	0.50	0.51	0.87	0.16
40912	43912	3/8"	0.53	0.53	0.36	0.87	0.36
40914	43914	7/16"	0.63	0.63	0.36	0.87	0.36
40916	43916	1/2"	0.67	0.67	0.57	0.87	0.36
40918	43918	5/16"	0.78	0.78	0.57	0.88	0.33
40920	—	5/8"	0.87	0.87	0.56	0.88	0.38

No. 4946

10 Piece, 1/4" Drive, 12 Point, Standard Fractional Socket Set Includes:

PART NO.	SIZE	PART NO.	SIZE	PART NO.	SIZE	PART NO.	SIZE
43906	3/16"	43909	9/32"	43912	3/8"	43918	5/16"
43907	7/32"	43910	5/16"	43914	7/16"		
43908	1/4"	43911	11/32"	43916	1/2"		

Packaged on a rail.