

## Professional Ratchets

### Made in the U.S.A.

You can count on the quality workmanship and value of these American made sockets.



### Smooth Ratcheting Action

Completely enclosed ratchet mechanism with triple tooth contact for smooth ratcheting action with little back movement. Diamond knurled grip for sure handling.

### SuperKrome® Finish

High polish SuperKrome® plating results in a jewelry-like finish, providing long life and maximum corrosion resistance.

**SUPERKROME  
TESTED TOUGH**

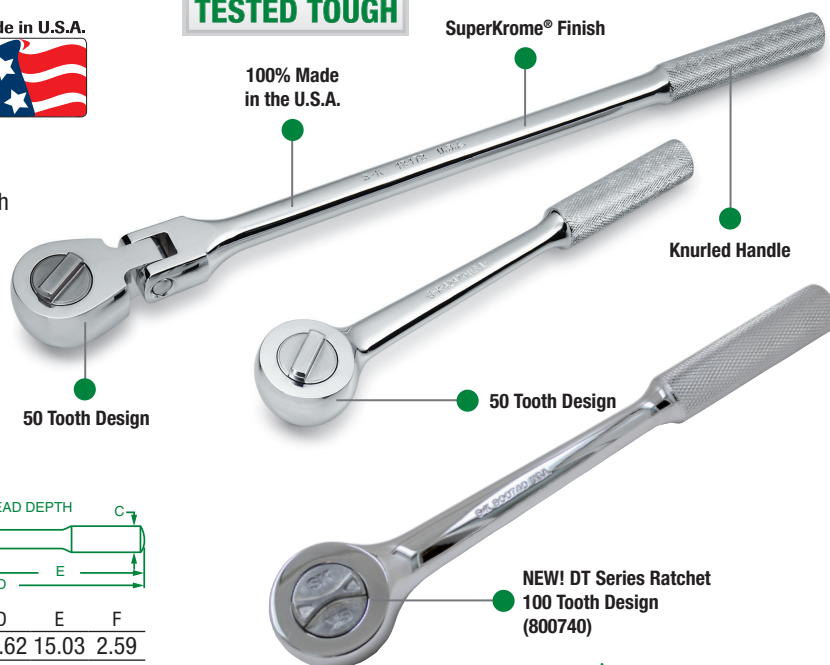

### 1/2" Drive Professional Flex Head Ratchet

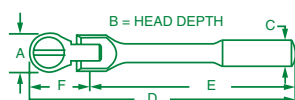

PART NO.	SIZE	A	B	C	D	E	F
<b>42472</b>	17.6"	1.86	0.80	0.75	17.62	15.03	2.59

### Rebuild and Repair Kits for 42472

REBUILD KIT* PART NO.	REPAIR KIT** PART NO.
<b>42470-2</b>	<b>42470-9</b>

\*Kit Includes: Cap, Inner Body, Clip Spring and Grease

\*\*Kit Includes: Pawl, Stem Pin, Clip Spring and Grease



### 1/2" Drive Flex Head Handles

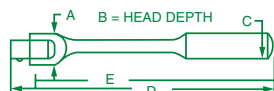

PART NO.	REPAIR KIT* PART NO.	REPAIR KIT** PART NO.	SIZE	A	B	C	D	E
<b>41650</b>	—	—	9"	1.10	0.87	0.75	9.00	7.95
<b>41652</b>	<b>41653-9</b>	<b>41654-9A</b>	16"	1.10	0.87	0.75	16.00	15.03
<b>41654</b>	<b>41653-9</b>	<b>41654-9A</b>	24"	1.10	0.87	1.00	23.50	22.50
<b>41656</b>	—	<b>41654-9A</b>	30"	1.10	0.87	1.02	30.62	30.00

\*Kit Includes: Pin, Lockwasher, and Square Drive Head

\*\*Kit Includes: Screw, Lockwasher, and Square Drive Head



### 1/2" Drive Speeder Handle

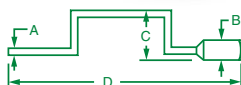

PART NO.	SIZE	A	B	C	D
<b>40181</b>	18.1"	0.50	0.78	4.53	18.12

### 1/2" Drive Reversible Ratchets

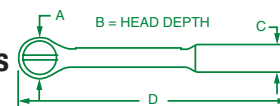

PART NO.	REBUILD KIT* PART NO.	REPAIR KIT** PART NO.	SIZE	A	B	C	D
<b>42470</b>	<b>42470-2</b>	<b>42470-9</b>	10.3"	1.85	0.80	0.84	10.25
<b>40170</b>	<b>42470-2</b>	<b>42470-9</b>	15"	1.94	0.80	0.81	15.06
<b>800740</b>	<b>800740-2</b>	—	10.3"	1.85	0.80	0.84	10.25

\*Kit Includes: Cap, Inner Body, Clip Spring and Grease

\*\*Kit Includes: Pawl, Stem Pin, Clip Spring and Grease



### 1/2" Drive Sliding T-Handle

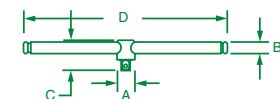

PART NO.	SIZE	A	B	C	D
<b>40150</b>	10.8"	0.91	0.55	1.61	10.83

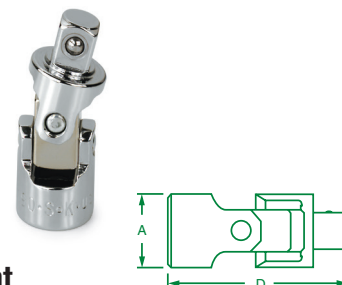

### 1/2" Drive Universal Joint

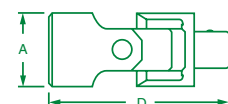

PART NO.	A	D
<b>40190</b>	1.00	2.61



Ratchet Rebuild Kit



Ratchet Repair Kit



## Rebuild and Repair Kits for Professional Bent, Slim, Reversible, and Flex Ratchets

PART NO.	DRIVE	DESCRIPTION	REBUILD KIT* PART NO.	REPAIR KIT** PART NO.	PIN, LOCKWASHER PART NO.	SCREW, WASHER PART NO.
<b>40970</b>	1/4"	4.5" Professional Reversible Ratchet	<b>40970-2</b>	<b>40970-9A</b>	—	—
<b>40972</b>	1/4"	6.3" Professional Flex Head Ratchet	<b>40970-2</b>	<b>40970-9A</b>	—	—
<b>40971</b>	1/4"	6.5" Professional Reversible Ratchet	<b>40970-2</b>	<b>40970-9A</b>	—	—
<b>800700</b>	1/4"	4.5" DT 120 Ratchet	<b>800700-2</b>	—	—	—
<b>45173</b>	3/8"	4.5" Professional Reversible Slim Ratchet	<b>45173-2</b>	<b>40970-9A</b>	—	—
<b>45174</b>	3/8"	4.8" Professional Reversible Stubby Ratchet	<b>45170-2</b>	<b>45170-9</b>	—	—
<b>45178</b>	3/8"	5" Professional Stubby Flex Head Ratchet	<b>45170-2</b>	<b>45170-9</b>	<b>3770-9</b>	<b>3770-9A</b>
<b>3767</b>	3/8"	6.3" Professional Slim Flex Head Ratchet	<b>45173-2</b>	<b>40970-9A</b>	—	—
<b>45171</b>	3/8"	6.5" Professional Reversible Slim Ratchet	<b>45173-2</b>	<b>40970-9A</b>	—	—
<b>45170</b>	3/8"	7.6" Professional Reversible Ratchet	<b>45170-2</b>	<b>45170-9</b>	—	—
<b>45179</b>	3/8"	10.3" Professional Reversible Ratchet	<b>45170-2</b>	<b>45170-9</b>	—	—
<b>3770</b>	3/8"	10.8" Professional Bent Flex Head Ratchet	<b>45170-2</b>	<b>45170-9</b>	<b>3770-9</b>	<b>3770-9A</b>
<b>45183</b>	3/8"	10.9" Professional Flex Head Ratchet	<b>45170-2</b>	<b>45170-9</b>	<b>3770-9</b>	<b>3770-9A</b>
<b>45172</b>	3/8"	Professional Thumbwheel Ratchet	<b>45173-2</b>	<b>40970-9A</b>	—	—
<b>800720</b>	3/8"	7.6" DT 80 Ratchet	<b>800720-2</b>	—	—	—
<b>42470</b>	1/2"	10.3" Professional Reversible Ratchet	<b>42470-2</b>	<b>42470-9</b>	—	—
<b>40170</b>	1/2"	15" Professional Reversible Ratchet	<b>42470-2</b>	<b>42470-9</b>	—	—
<b>42472</b>	1/2"	17.6" Professional Flex Head Ratchet	<b>42470-2</b>	<b>42470-9</b>	<b>41653-9</b>	<b>41654-9A</b>
<b>800740</b>	1/2"	10.3 DT 100 Ratchet	<b>800740-2</b>	—	—	—
<b>47170</b>	3/4"	18" Professional Reversible Ratchet	<b>47170-2</b>	<b>47170-9</b>	—	—

\*Kit Includes: Cap, Inner Body, Clip Spring and Grease

\*\*Kit Includes: Pawl, Stem Pin, Clip Spring and Grease

## Repair Kits for Flex Head and Sliding T-Handles

Screw Kit



Pin Kit



PART NO.	DRIVE	DESCRIPTION	REPAIR KIT PART NO.	REPAIR KIT INCLUDES
<b>41652</b>	1/2"	16" Flex Head Handle	<b>41653-9</b>	Pin, Lockwasher, and Square Drive Head
<b>41652</b>	1/2"	16" Flex Head Handle	<b>41654-9A</b>	Screw, Lockwasher, and Square Drive Head
<b>41654</b>	1/2"	24" Flex Head Handle with Indexing Head	<b>41653-9</b>	Pin, Lockwasher, and Square Drive Head
<b>41654</b>	1/2"	24" Flex Head Handle with Indexing Head	<b>41654-9A</b>	Screw, Lockwasher, and Square Drive Head
<b>45152</b>	3/8"	10" Flex Head Handle	<b>45152-9A</b>	Screw, Lockwasher, and Square Drive Head
<b>40952</b>	1/4"	5.4" Flex Head Handle	<b>40952-9A</b>	Screw, Lockwasher, and Square Drive Head
<b>47155</b>	3/4"	18" Flex Head Handle	<b>47155-9</b>	Screw, Lockwasher, and Square Drive Head

## Repair Parts for Spark Plug Sockets



PART NO.	DRIVE	DESCRIPTION	REPAIR KIT PART NO.	REPAIR KIT INCLUDES
<b>4420</b>	3/8"	5/8" Spark Plug Socket	<b>4447</b>	5/8" x 3/4" Rubber Insert
<b>4424</b>	3/8"	3/4" Spark Plug Socket	<b>4447</b>	5/8" x 3/4" Rubber Insert
<b>4426</b>	3/8"	13/16" Spark Plug Socket	<b>4448</b>	3/16" Rubber Insert
<b>4421</b>	3/8"	5/8" Extra Long Spark Plug Socket	<b>4447</b>	5/8" x 3/4" Rubber Insert
<b>4480</b>	3/8"	5/8" Flex Spark Plug Socket	<b>4447</b>	5/8" x 3/4" Rubber Insert
<b>4490</b>	3/8"	13/16" Flex Spark Plug Socket	<b>4448</b>	3/16" Rubber Insert
<b>4820</b>	1/2"	5/8" Spark Plug Socket	<b>4447</b>	5/8" x 3/4" Rubber Insert
<b>4826</b>	1/2"	13/16" Spark Plug Socket	<b>4448</b>	3/16" Rubber Insert