

# SURE SHOT® SPRAYERS

## INSTRUCTIONS

Refillable, reusable. Extra versatile.  
Pressurized by free air



### DIRECTIONS FOR OPERATING MODEL “M” SPRAYERS

- 1) ALWAYS DEPRESSURIZE SPRAYER BEFORE REMOVING ANY PARTS.** The pressure may be let out of the sprayer one of the two following ways:
  - a) Tip the sprayer upside down and depress the trigger until no pressure is left. If some liquid is left in the sprayer when you attempt this procedure make sure you aim the nozzle at a place where a little bit of liquid can be expelled.
  - b) Remove #122 black cap from air filler and use small probe to depress #121 valve core until all the pressure escapes. **NOTE:** Make sure the sprayer is upright and the air filler stem is pointing away from you when depressing the valve core.
  - c) Remove the complete top assembly from the canister once all the air has been let out. Do this by grasping the body in one hand and the canister in the other while unscrewing counterclockwise completely.
- 2) Fill sprayer 2/3 full (24 ounce maximum liquid capacity) with light, clean liquid.** Make sure the liquid you are putting into the sprayer is **CLEAN** and **FREE OF FOREIGN PARTICLES**. See **ACCESSORIES** on page 3 for liquid filling/measuring device.

**NOTE: ALWAYS CHECK WITH YOUR CHEMICAL SUPPLIER IF YOU ARE NOT SURE OF COMPATIBILITY. READ CAUTION LABEL ON SPRAYER BEFORE FILLING. NEVER USE ACIDS IN ANY SURE SHOT SPRAYER.**

- 3) Take the complete top assembly and screw it clockwise into top of the canister.** Firmly hand tighten only.
- 4) Charge sprayer with compressed air by holding standard air chuck on valve stem of the air filler.** Hold the air chuck on the air filler until you hear the line pressure equalize with the sprayer. Working pressure is 80-150 psi. At least 80 psi is needed to spray the full 24 oz. without a recharge of air. **THE MAXIMUM PRESSURE SHOULD NOT EXCEED 200 PSI.**
- 5) The Model “M” sprayer is now ready to use.**
- 6) For best results, the liquid to be sprayed should be lighter than a No. 10 motor oil.** (If liquid is too heavy a pin stream will result). **DILUTE WITH A SUITABLE DILUENT UNTIL DESIRED SPRAY IS OBTAINED.**

**CAUTION:** Never point the nozzle of sprayer toward yourself or another person. Always point the nozzle of the sprayer away from yourself and toward your intended target before depressing the trigger.

**ALWAYS DEPRESSURIZE THE SPRAYER BEFORE REMOVING ANY PARTS**  
**SPRAYER NOT RECOMMENDED FOR USE WITH PAINTS**  
**MAXIMUM PRESSURE 200 PSI**



## MODEL M SPRAYER

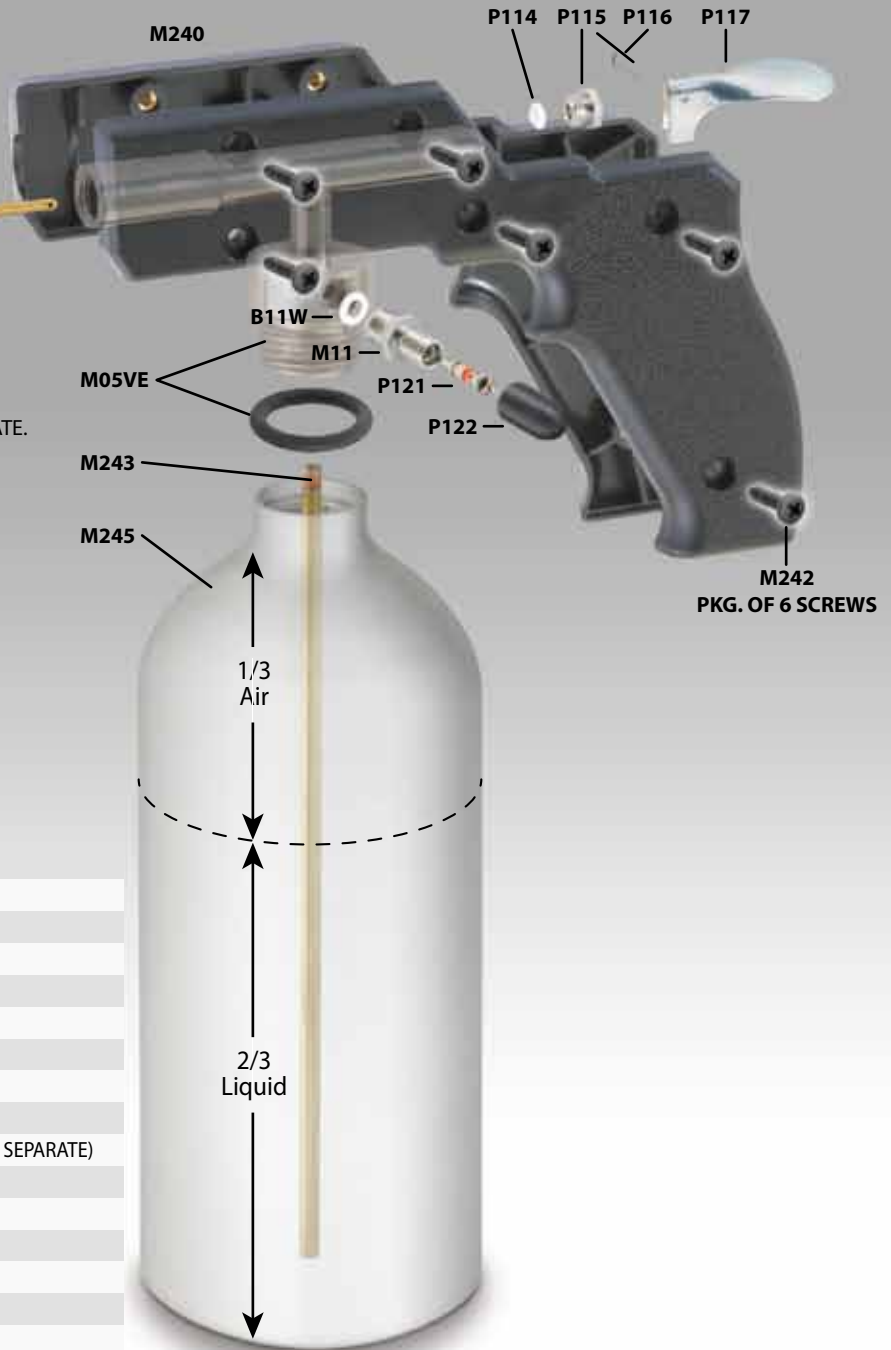

- B11W** TEFLON® WASHER
- M05VE** O'RING
- M11** AIR FILLER ASSEMBLY (INCLUDES B11W, P121, P122)
- M240** ACETAL PLASTIC HANDLE
- M242** HANDLE SCREWS (PKG. OF 6)
- M243** BRASS SIPHON TUBE
- M245** 24 OZ. CAPACITY CANISTER (BLACK OR SILVER)
- P108** INNER ADAPTER WASHER
- P110** VALVE (INCLUDES P111)
- P111** VALVE SPRING (INCLUDED WITH P110, NOT AVAILABLE SEPARATE)
- P114** STUFFING BOX PACKING
- P115** STUFFING BOX NUT
- P116** COTTER PIN
- P117** VALVE TRIGGER
- P121** CHEMICAL RESISTANT VALVE CORE
- P122** BLACK CAP
- P602** ADJUSTABLE NOZZLE (MIST TO STREAM)

| <b>PART #</b> | <b>DESCRIPTION</b>   |
|---------------|--|
| B11W          | Teflon® Washer   |
| M05VE         | O'Ring   |
| M11           | Air Filler Assembly<br>(Incl. B11W, P121, P122)                |
| M240          | Acetal Plastic Handle  |
| M242          | Handle Screws (Pkg. of 6)                                      |
| M243          | Brass Siphon Tube  |
| M245          | 24 oz. Capacity Anodized Canister<br>(Black or silver)         |
| P108          | Inner Adapter Washer   |
| P110          | Valve (Includes P111)  |
| P111          | Valve Spring (Included With P110,<br>Not Available Separately) |
| P114          | Stuffing Box Packing   |
| P115          | Stuffing Box Nut   |
| P116          | Cotter Pin   |
| P117          | Valve Trigger  |
| P121          | Chemical Resistant Valve Core                                  |
| P122          | Black Cap  |
| P307          | Valve Seat Adapter - Male                                      |
| P307-C        | Valve Seat Adapter - Female<br>1/8" NPT                        |
| P307PT        | Valve Seat Adapter - Male<br>1/8" NPT                          |
| P309          | Outer Adapter Washer   |

| <b>NOZZLES</b> |   |
|----------------|---|
| <b>PART #</b>  | <b>DESCRIPTION</b>  |
| P223A<br>P302  | Spray Jet Spiral (For P305)<br>Regular Spray Nozzle<br>(Incl. P303, P309)<br>Remove P303 With Needle Nose<br>Pliers To Produce Pin Stream |
| P302-B         | Coarse Spray Nozzle<br>(Incl. P303, P309)   |
| P302-C         | Extra Fine Spray Nozzle<br>(Incl. P303, P309)   |
| P303           | Spray Jet Spiral<br>(Fits P302, P302-B, P302-C)   |
| P305           | Fine Spray Nozzle<br>(Incl. P223A, P108)  |
| P501           | Flat Spray Nozzle<br>(Incl. P307-C, P108)   |
| P550           | Flat Spray Nozzle<br>(Incl. P307-C, P108)   |
| P567           | Coarse Flat Spray Nozzle<br>(Incl. P307-C, P108)  |
| P602           | Adjustable Nozzle With Adapter<br>(Incl. P108)  |
| P707           | Extra, Extra Fine Spray Nozzle<br>(Incl. P108)  |

| <b>EXTENSIONS</b> |   |
|-------------------|---|
| 304               | Nozzle Extension Washer<br>(for 325 & 335)  |
| 320               | 3" Extension with Sprayhead   |
| 325               | 6" Nozzle Extension - Rigid Brass<br>(for 302/302B/302C/501)                        |
| 330               | 12" Nozzle Extension -<br>Long Flexible Teflon® Tube<br>(for 301/302/302B/302C/501) |
| 331               | 12" Nozzle Extension -<br>Long Flexible Teflon® Tube<br>(for 305/550/567/602/707)   |
| 338               | 6" Nozzle Extension - Rigid Brass<br>(for 305/550/567/602/707)                      |
| 335               | 12" Nozzle Extension - Flexible Brass<br>(for 302/302B/302C/501)                    |
| 339               | 12" Nozzle Extension - Flexible Brass<br>(for 305/550/567/602/707)                  |
| 337               | 12" Plastic Pin Stream Extension  |
| 344               | 3" Long Hypodermic Tube Extension   |
| 345               | 3" Extension with Pin Stream Head   |

### **ACCESSORIES**

P07362



Filling/Measuring Device  
32 ounce Capacity: Graduations  
at 8, 16, 24, and 32 oz. Includes  
Brass Mesh Screening

## **REPAIR PROCEDURES**

The following is the correct order and way to remove and replace all the parts on your Model "M" Sprayer.

- a) **ALWAYS DEPRESSURIZE SPRAYER BEFORE REMOVING ANY PARTS.** (See page 1)
- b) Remove the complete top assembly from the canister once all the air has been let out of the sprayer. Do this by grasping the body in one hand and the canister in the other and unscrewing counterclockwise completely.
- c) Take a pliers and remove the P116 cotter pin from the P117 trigger and remove the trigger.
- d) Remove the P602 nozzle using a 5/8" wrench.
- e) Remove the P115 nut using a 3/8" wrench.
- f) Remove the P110 valve. Note that the P111 spring is assembled to the P110 valve.
- g) You will most likely damage the P114 when you remove it. Be careful not to damage the inside threads when removing the P114. The P114 stuffing box packing may be removed by taking a small thin flat blade screwdriver and working the P114 loose.
- h) Remove the B05VE O'Ring from the body.
- i) Remove the 7/16" hex M11 air filler assembly from the side of the body. The B11W washer must also be removed and replaced. You have now removed all the parts from the sprayer.
- j) To reassemble using your KM10 complete repair kit, start by taking a P114 and placing it into the position you just removed it from. Take the P115 and just hand start the thread.
- k) Take the P111 valve spring and assemble it to the P110 valve and place whole assembly into sprayer.
- l) Take a P108 washer and assemble to the back of the P602 nozzle. Take the assembly and push the face of the P110 back into the sprayer until you can hand start the thread. Tighten the 5/8" hex until washer is seated.

- m) Snug 3/8" hex P115 stuffing box nut. Do not over-tighten.
- n) Replace P117 trigger. Line up the holes in the trigger with hole in the back of the P110 valve. Insert P116 cotter pin and using a pliers bend over the ends.
- o) Press down on the P117 trigger and apply a drop or two of lubricant to the valve stem of the P110 at the rear of the P115 stuffing box nut. Tilt the sprayer so that the lubricant runs into and around the P115.
- p) Pressurize sprayer and check for leaks.

## **CLEANING THE P110 VALVE**

- 1) **ALWAYS DEPRESSURIZE SPRAYER BEFORE REMOVING ANY PARTS.** (See page 1)
- 2) Remove the complete top assembly from the canister once all the air has been let out of the sprayer. Do this by grasping the body in one hand and the canister in the other and unscrewing counterclockwise completely.
- 3) Remove P602 nozzle by using 5/8" wrench on the hex portion of the P602 body. Clean nozzle.
- 4) The face of the P110 valve is now visible. The face should be clean and clear of all particles. You should see a circular depression caused by the back of the nozzle. This depression should be clean and clear of all debris. You can do this with a small brush.
- 5) Return P602 nozzle and P108 washer to the opening and tighten.
- 6) Depress the P117 trigger several times to reset the seal between the face of the P110 valve and the back of the nozzle.
- 7) Take the top assembly and screw it clockwise into the top of the canister. Firmly hand tighten only.
- 8) Pressurize and check for leaks. If valve does not seal correctly, replace the P110 valve.

# TROUBLE SHOOTING

## TROUBLE SHOOTING

### SPRAYER WILL NOT SPRAY AT ALL

- A) Sprayer is completely full of liquid. Only fill sprayer 2/3 full (24 ounces).
- B) No air pressure. Pressurize.
- C) Nozzle is clogged. Clean or replace nozzle.

### PIN STREAM ONLY

- A) Liquid too thick. Thin until sprayable. Consult your liquid supplier for correct thinning procedures.
- B) Too little air pressure. Minimum of 80 psi.

### LEAKS FROM P115 STUFFING BOX NUT

- A) P115 stuffing box nut is loose. Tighten P115 1/16th of a turn and apply a drop or two of lubricant to the P110 valve stem at the rear of the P115. Tilt the sprayer so that the lubricant runs into and around the P115. Depress trigger a few times to work in the oil.

### STUCK OR DRAGGING TRIGGER ACTION

- A) P115 stuffing box nut is too tight. Loosen P115 nut 1/16th of a turn and apply a drop or two of lubricant to the P110 valve stem at the rear of the P115. Tilt the sprayer so that the lubricant runs into and around the P115. Depress trigger to work in oil. Retighten slightly for proper action.

### AIR FILLER ASSEMBLY WON'T ACCEPT AIR

- A) Air filler assembly has been damaged. Replace.

### LEAKS FROM NOZZLE

- A) Dirty or worn face on P110 valve. (See Cleaning the P110 valve on previous page)
- B) P115 stuffing box nut is too tight. (See stuck or dragging trigger action on this page)

### LEAKS BETWEEN BODY AND CANISTER

- A) O'Ring is dirty. Clean and wet.
- B) O'Ring is damaged or worn. Replace.

**WARNING**

\*

**WARNING**

\*

**WARNING**

Sprayer Units returned to the factory containing **ANY LIQUIDS** will be returned to sender at their expense.

**WARRANTY**

SURE SHOT® SPRAYERS, Parts and Accessories are guaranteed against defective materials and workmanship under normal conditions of use and service for a period of ninety days from date of sale to the consumer or nine months from date of shipment from the factory, whichever transpires first. The obligation of the Company (Milwaukee Sprayer Mfg. Co., Inc.) shall be limited to repairing or replacing any sprayer, part or accessory which is found by the Company to be defective, provided that a written claim covering such defect is submitted within the warranty period. The Company shall in no event be liable for consequential damages arising out of a defect or failure in any sprayer, part or accessory, or for any loss arising from the use or resale of any such materials, the Company's liability being limited to repair or replacement of defective components as aforesaid. This warranty shall not apply to defects resulting from accident, alterations, abuse or misuse, including the use of solutions containing ammonia in any Sure Shot® Sprayer. Although it shall be the policy of the Company to be liberal in making adjustments, the settlement of claims regarding product defects will be governed by the provisions of this warranty. No other warranty, expressed or implied, is made by Milwaukee Sprayer Mfg. Co., Inc. with respect to any sales or products referred to herein.

Suspect defective sprayers should be returned to the factory for examination. All sprayers returned to the factory for examination and/or repair must be sent to the address shown below with transportation charges prepaid. If the defects are covered by the above warranty, the least expensive inbound and outbound transportation charges in connection with repairing or replacing such defects will be borne by the factory. All returned repairable sprayers not covered by the warranty will be reconditioned in accordance with the following schedule of reconditioning charges.

The logo for Sure Shot, featuring the words "sure" and "shot" in a bold, italicized, sans-serif font. "sure" is positioned above "shot", and a registered trademark symbol (®) is located to the upper right of "shot".**MILWAUKEE SPRAYER MFG. CO., INC.**

N90 W14337 COMMERCE DRIVE MENOMONEE FALLS, WISCONSIN 53051  
(262) 437-0330 • TOLL FREE: 800-558-7035 (including Canada) • FAX: (262) 437-0100  
EMAIL: sureshot@sureshotsprayer.com • WEBSITE: www.sureshotsprayer.com